

PUD - CONSTRUIRE LOCUINTA INDIVIDUALA

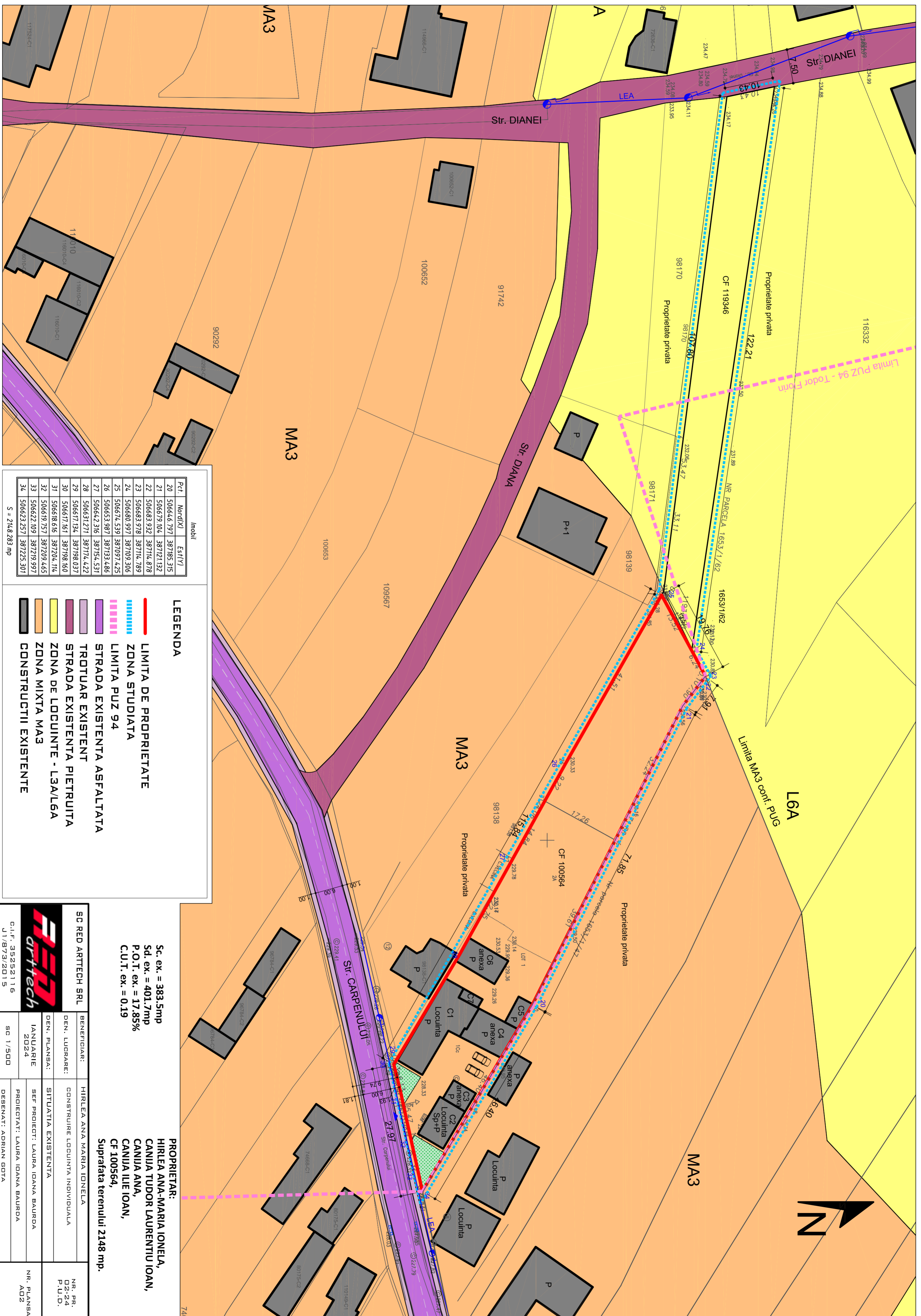

| Pct. | Nord(X) | Est(Y) |
|------|------------|------------|
| 20 | 506646,797 | 387185,315 |
| 21 | 506679,104 | 387121,132 |
| 22 | 506683,932 | 387114,878 |
| 23 | 506683,978 | 387114,789 |
| 24 | 506680,927 | 387109,306 |
| 25 | 506674,539 | 387097,425 |
| 26 | 506653,987 | 387133,486 |
| 27 | 506642,316 | 38754,531 |
| 28 | 506631,271 | 387114,422 |
| 29 | 506617,134 | 387198,037 |
| 30 | 506617,161 | 387198,160 |
| 31 | 506618,616 | 387204,114 |
| 32 | 506619,157 | 387209,465 |
| 33 | 506622,109 | 387219,997 |
| 34 | 506623,257 | 387225,301 |

S = 2148,283 mp

LEGENDA

- LIMITA DE PROPRIETATE
- ZONA STUDIATA
- LIMITA PUZ 94
- STRADA EXISTENTA ASFALTATA
- TROTUAR EXISTENT
- STRADA EXISTENTA PIETRUITA
- ZONA DE LOCUINTE - L3A/L6A
- ZONA MIXTA MA3
- CONSTRUCȚII EXISTENTE

| | | | | | |
|--------------------------|--|--|--|------------------------------|--|
| SC RED ARTECH SRL | | BENEFICIAR: HIRLEA ANA MARIA IONELA | | NR. PR. P.U.D.: 02-24 | |
| DEN. LUGRARE: | | CONSTRUIRE LOCUINTA INDIVIDUALA | | P.U.D.: | |
| DEN. PLANSĂ: | | SITUATIA EXISTENTA | | NR. PLANSA: | |
| IANUARIE 2024 | | SEF PROIECT: LAURA IOANA BAURDA | | A02 | |
| C.I.F.: 35252116 | | PROIECTAT: LAURA IOANA BAURDA | | | |
| J1/873/2015 | | DESEMNAT: ADRIAN GOTĂ | | | |

Sc. ex. = 383,5mp
Sd. ex. = 401,7mp
P.O.T. ex. = 17,85%
C.U.T. ex. = 0,19

PROPRIETAR:
HIRLEA ANA-MARIA IONELA,
CANIUA TUDOR LAURENTIU IOAN,
CANIUA ANA,
CANIUA ILE IOAN,
CF 100564,
Suprafata terenului 2148 mp.